



LTS PRO-VS APP

Efficient, Reliable, Compatible



Clean & Minimalist UI

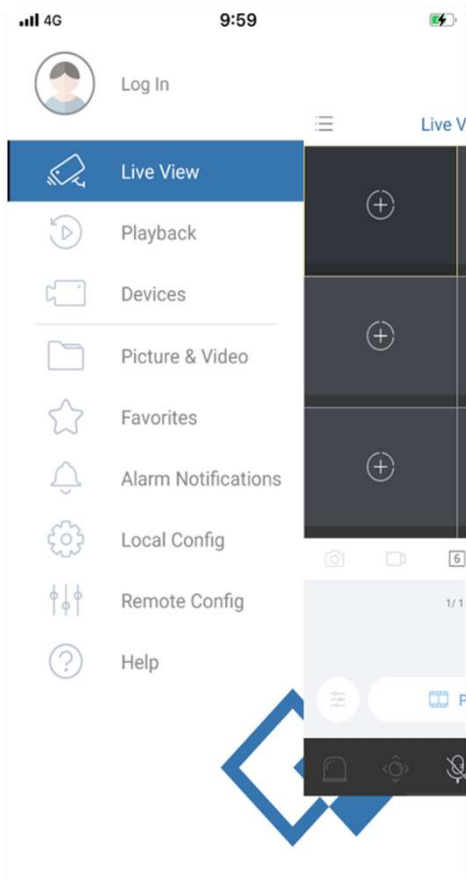

Account	Manage Cloud Account Device sharing
Live View	1/4/9/16 split view and more
Playback	4-ch playback, snapshot and more
Devices	Add Devices via P2P/IP Up to 5,000 devices, 10,000 channels
Picture & Video	save image/video to cell phone
Favorites	specified video settings and the window layout
Alarm Notifications	Config alarm push by device/channel/time/alarm type; multiple alarm types including motion, tampering, VCA etc.
Local Config	Do Not Disturb, retrieve device password, and more.
Remote Config	Set NVR storage policy and recording schedule, reboot

Simple Device Add-On



Add device to account

- Signup a new account in app
- Scan device QR Code



Add without signup

- Scan device QR code and input password



Watch live view on app

Live View

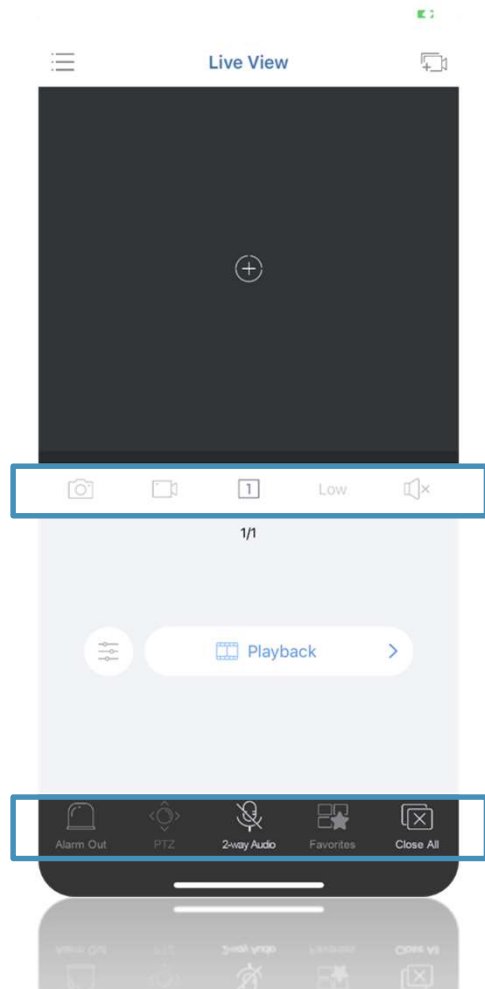

Snapshot
Manually Recording
Layout
Streams
Audio

Remote surveillance

1/4/9/16 split view, support main/ sub/ third stream, two-way audio, PTZ control, local recording, snapshot and more.
Auto-adjust stream according to window layout.

Alarm Out
PTZ Control
Two-way Audio
Saved Layout
Close All

Playback

4 channel playback with progress/ speed control

- Search video by recording type
- Zoom in on the timeline for precise progress control
- A variety of speeds available

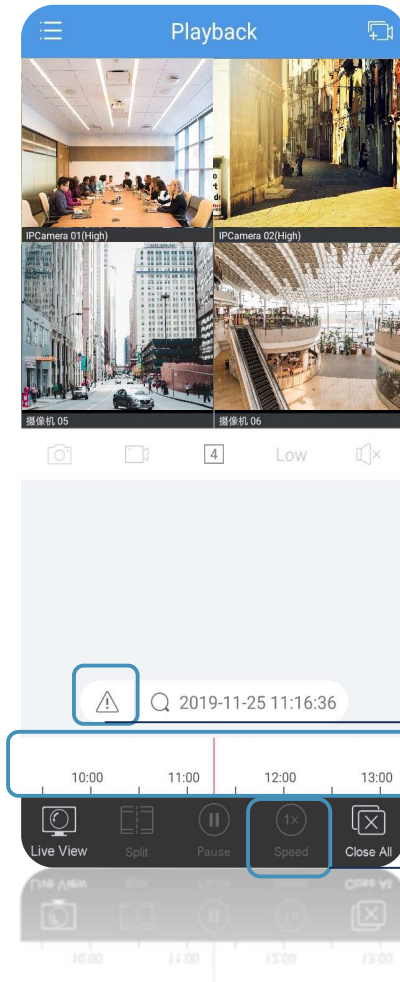

Search specific recording type(s)

Zoom in/ out on timeline with gestures (60/30/10/5 scales)

Speed control

Recording Type

ALL	<input checked="" type="checkbox"/>
<input checked="" type="checkbox"/> Motion Detection	<input checked="" type="checkbox"/>
<input checked="" type="checkbox"/> VCA	<input checked="" type="checkbox"/>
<input checked="" type="checkbox"/> Alarm	<input checked="" type="checkbox"/>
<input checked="" type="checkbox"/> Normal	<input checked="" type="checkbox"/>

OK

OK

Normal

Playback

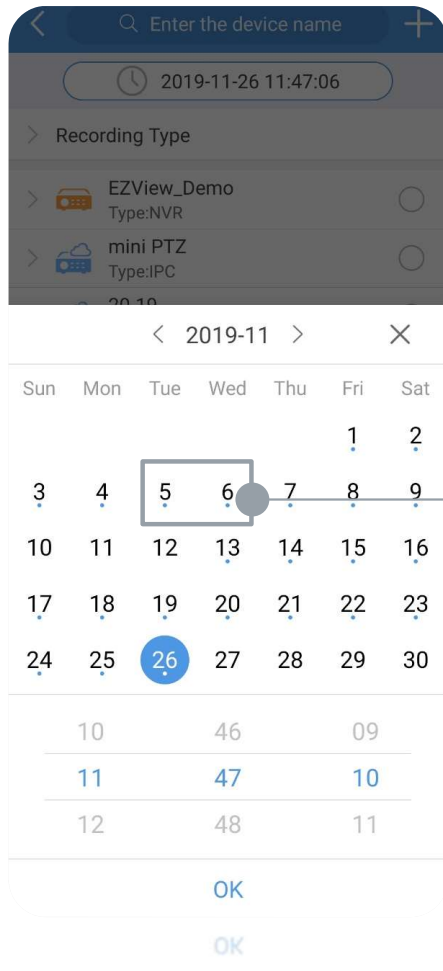

Recording search:
A blue dot indicates there are recordings

Blue dot below the date

Device List

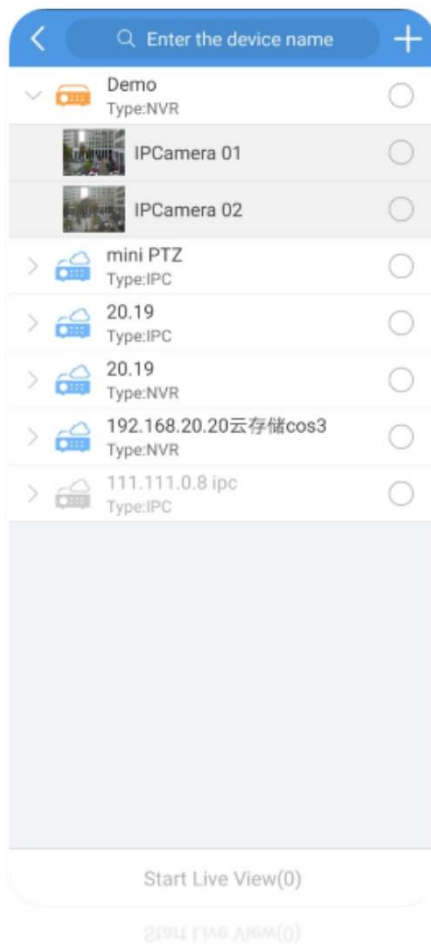

Quick device lookup with thumbnail images

- Users can by search device name
- Automatic snapshot as thumbnail image

Device List – Speed Test

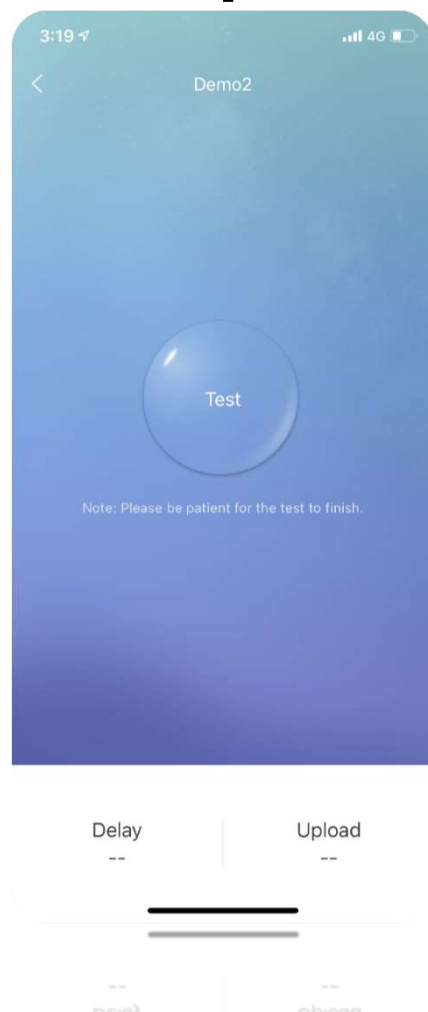
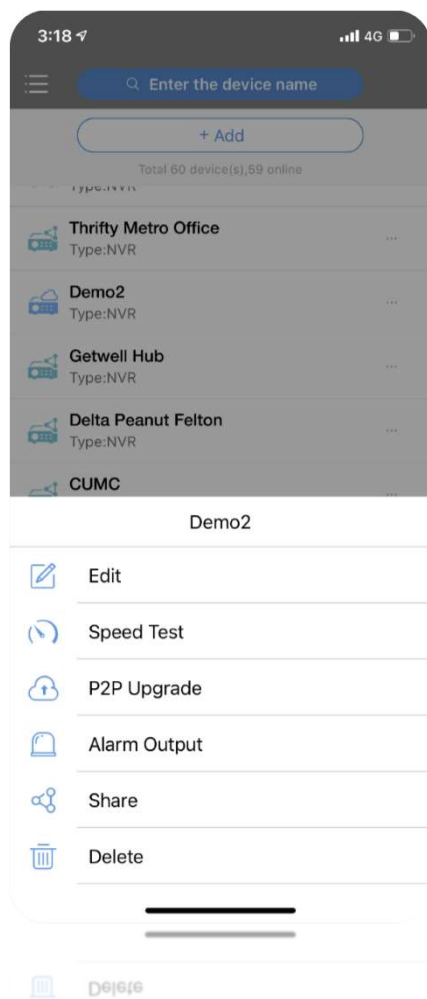

Upload Speed Test

Simple trouble shooting for lagging and network issues

Device List – P2P Upgrade

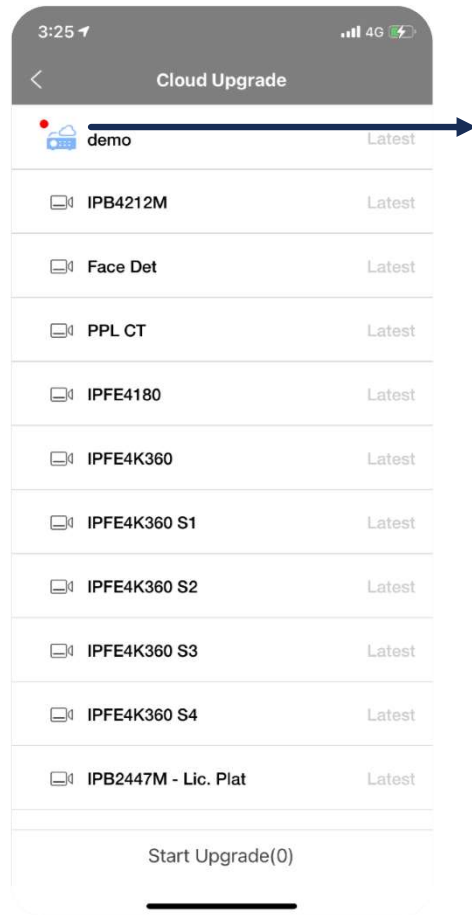
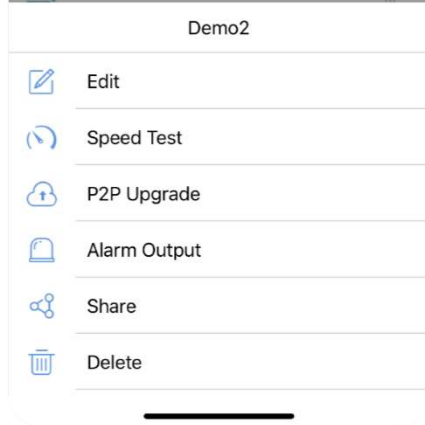
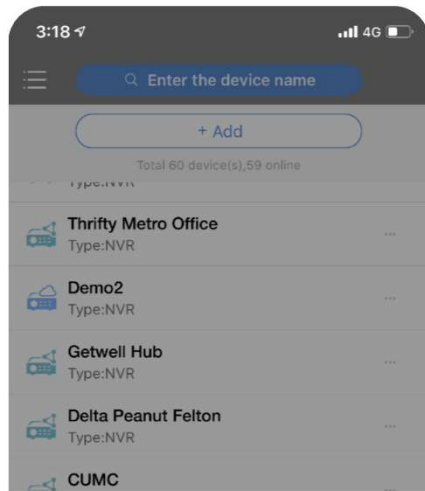

Red dot indicates
new firmware notifications

Device List – Share

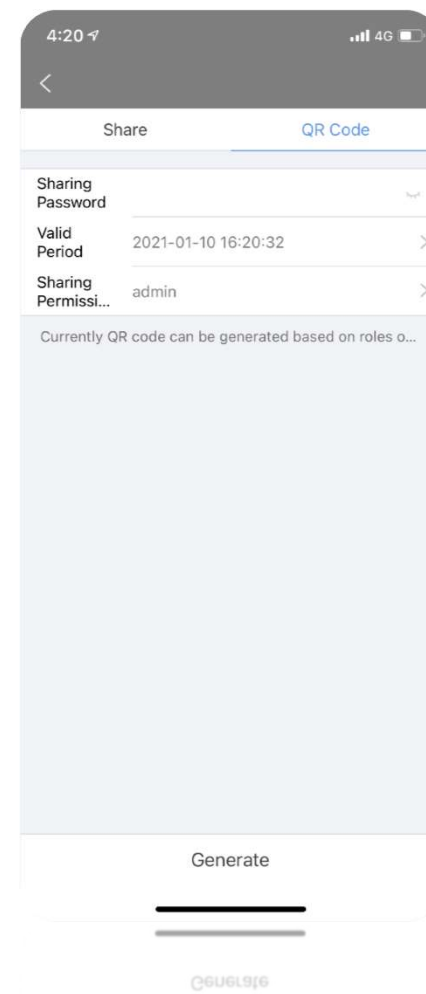
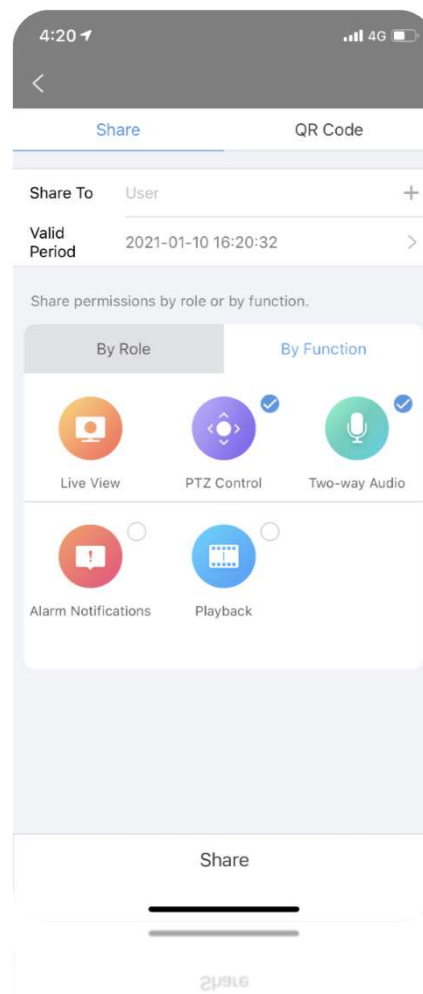
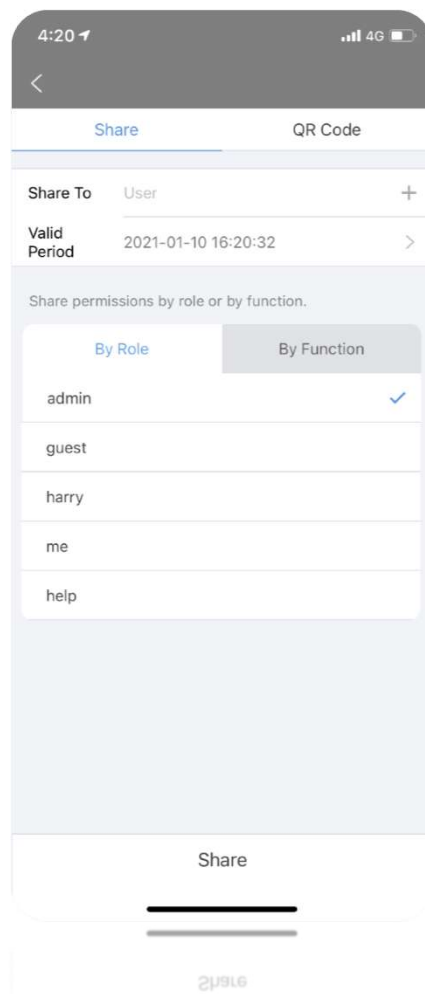
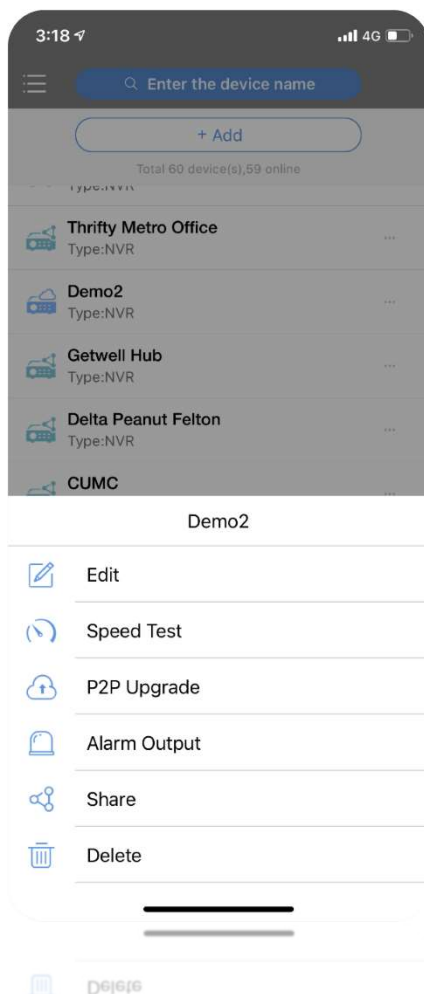

Favorites

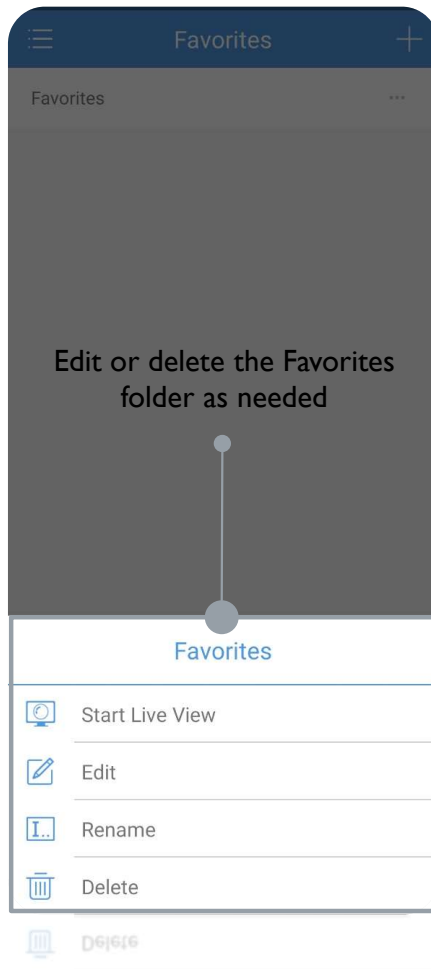

- Create a Favorites folder to save channels and the window layout
- Edit or delete channels in a favorites folder as needed
- One tap of the button starts all videos

Alarm Notifications

Only receive alerts for your customized items

Configure notifications based on channel, time and type to receive certain alarms and avoid unnecessary alerts.

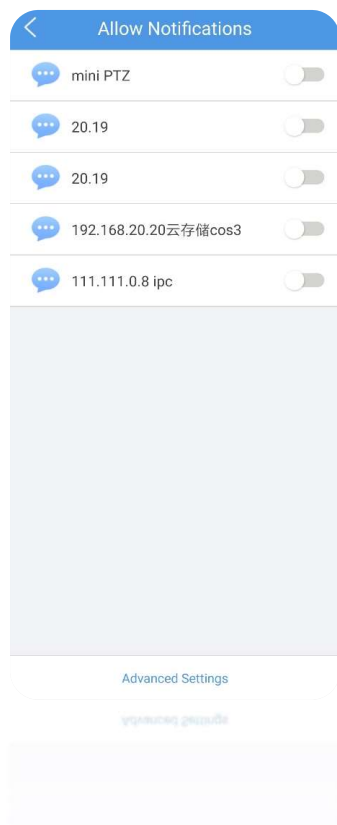

Allow Notifications

mini PTZ ☐

20.19 ☐

20.19 ☐

192.168.20.20云存储cos3 ☐

111.111.0.8 ipc ☐

Advanced Settings



20.19

Channel	Time	Type
Select All		<input type="checkbox"/>
20.19		<input checked="" type="checkbox"/>
摄像机 03		<input type="checkbox"/>
摄像机 04w		<input type="checkbox"/>
摄像机 05		<input type="checkbox"/>
摄像机 06		<input type="checkbox"/>
摄像机 07		<input type="checkbox"/>
摄像机 08		<input type="checkbox"/>
摄像机 09		<input checked="" type="checkbox"/>
摄像机 10		<input type="checkbox"/>
摄像机 11		<input type="checkbox"/>
摄像机 12		<input type="checkbox"/>

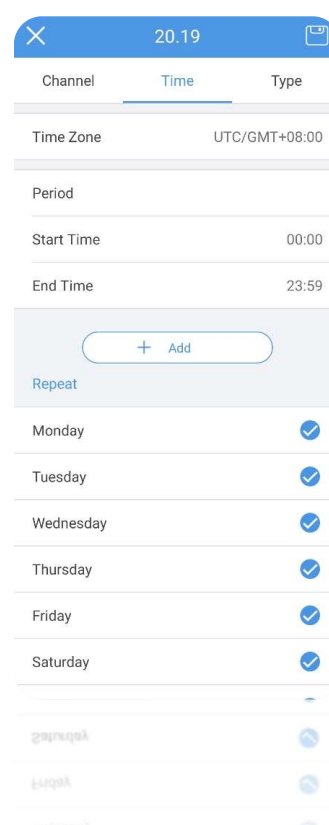

20.19

Channel	Time	Type
Time Zone	UTC/GMT+08:00	
Period		
Start Time	00:00	
End Time	23:59	
+ Add		
Repeat		
Monday	<input checked="" type="checkbox"/>	
Tuesday	<input checked="" type="checkbox"/>	
Wednesday	<input checked="" type="checkbox"/>	
Thursday	<input checked="" type="checkbox"/>	
Friday	<input checked="" type="checkbox"/>	
Saturday	<input checked="" type="checkbox"/>	

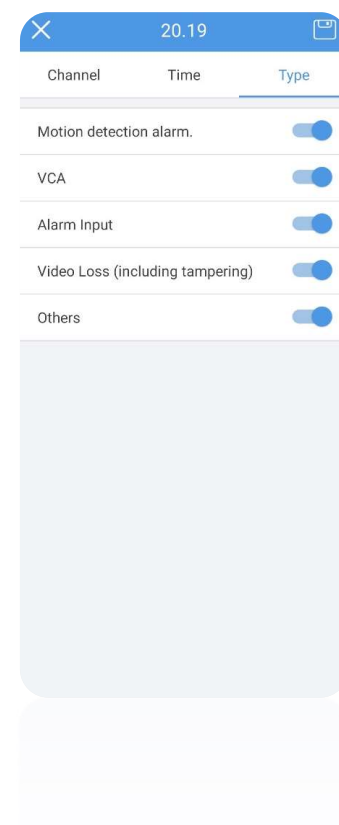

20.19

Channel	Time	Type
Motion detection alarm.		<input checked="" type="checkbox"/>
VCA		<input checked="" type="checkbox"/>
Alarm Input		<input checked="" type="checkbox"/>
Video Loss (including tampering)		<input checked="" type="checkbox"/>
Others		<input checked="" type="checkbox"/>

Alarm Notifications

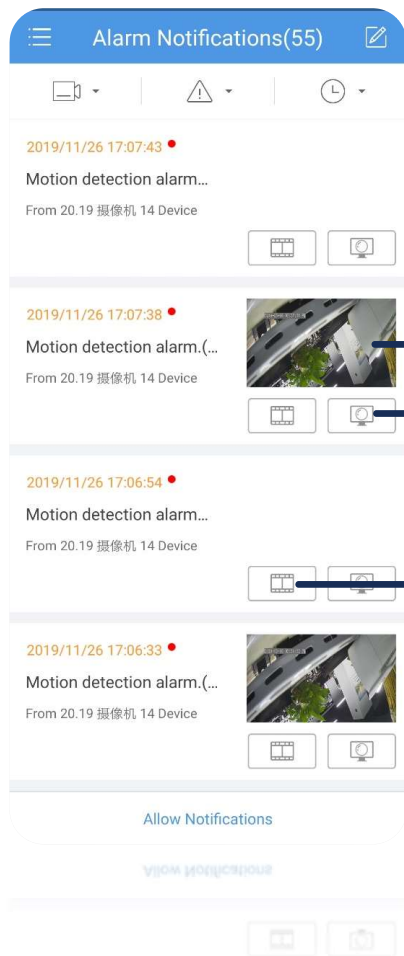

Alarm Snapshot

Live View

Event Video



Filter alarm records by devices, channels, times and alarm types

Remote Configuration

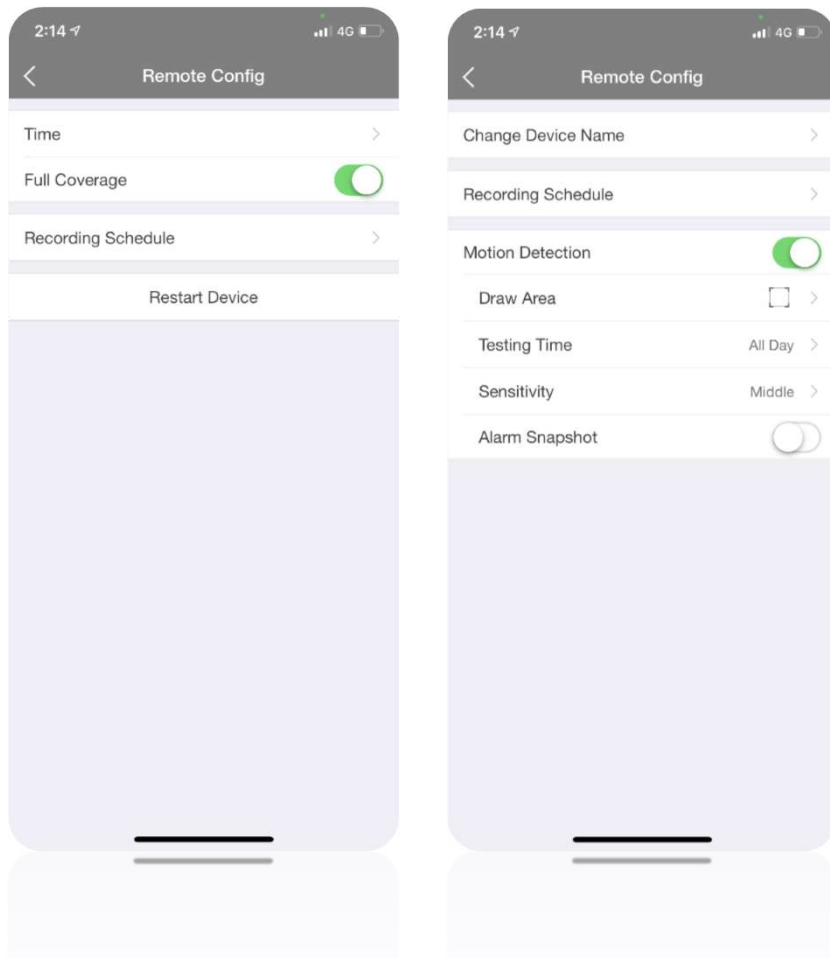

NVR:

Set time, storage policy, recording schedule, and restart device

NVR Channel:

- Change device name
- Configure recording schedule by selecting recording types and specifying recording time
- Modify motion detection including area, time, sensitivity and snapshot