

# PT Cloud Method

For the PT Cloud method to work, the device must be bound to a PT Cloud account. The LTS Connect app that will be used to reset the password must be logged into the same account that has the device.

1. On the NVR, navigate to the password reset menu, select PT Cloud option, and then click next.

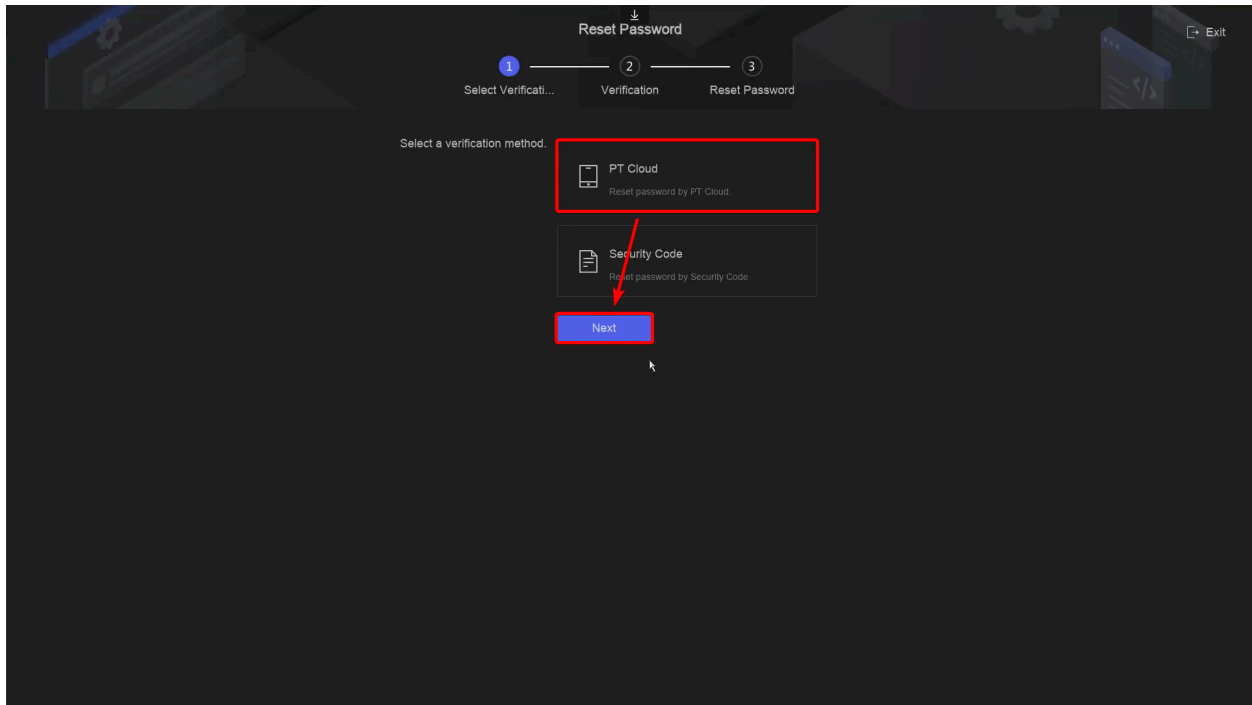



2. On this new page, select PT Cloud and then click next.

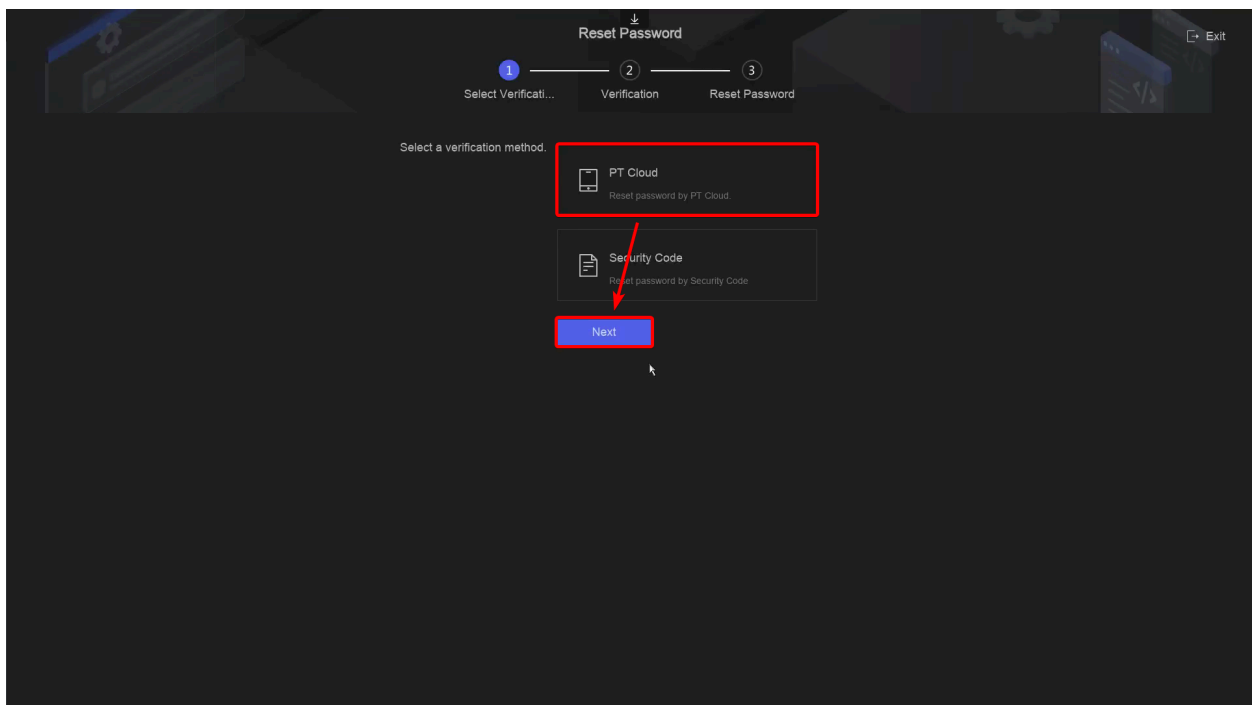

3. On the next page, there will be 2 QR Codes presented. The one on the RIGHT is the one to be scanned in LTS Connect.

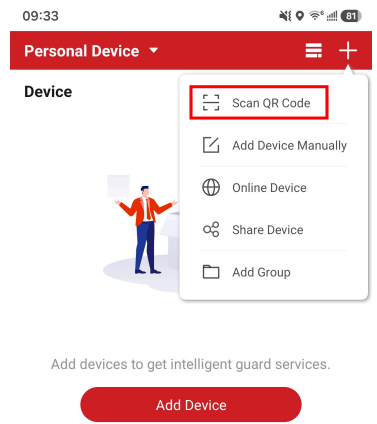
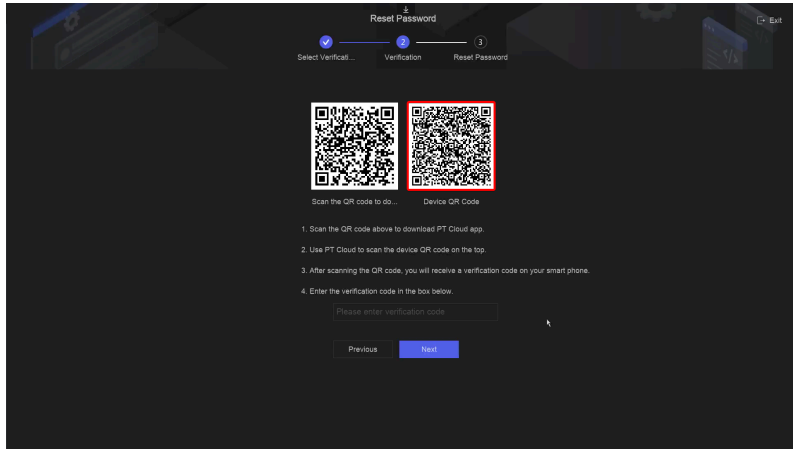

4. After scanning the QR code, LTS Connect will display a verification code. Type this into the verification code field and then click next.

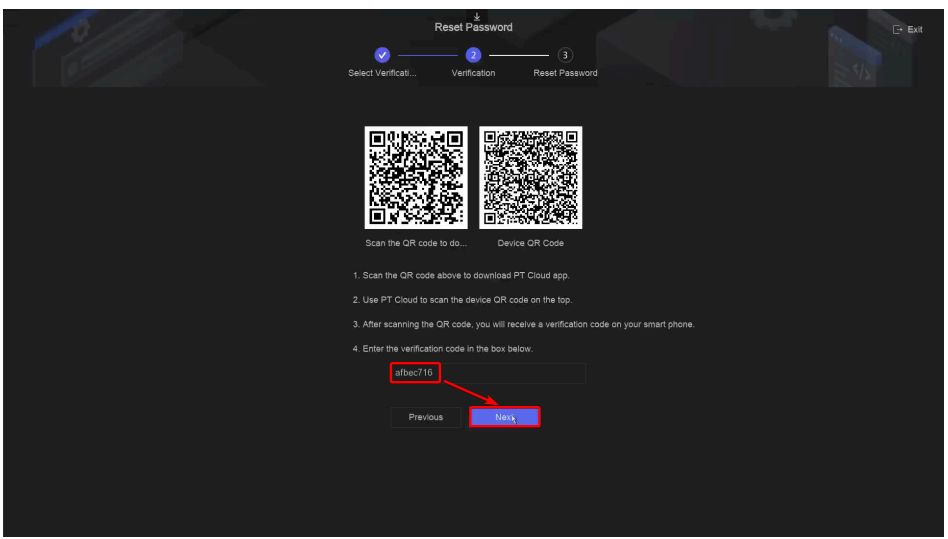
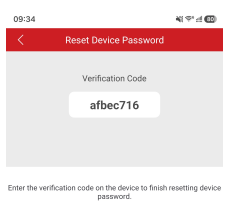

5. Now create a new password for the recorder. After clicking next, there will be a prompt to duplicate the password to channel default password, click ok. The password reset process is now finished.

